



GameTime  
c/o Dominica Recreation Products, Inc.  
P.O. Box 520700  
Longwood, FL 32752-0700  
800-432-0162 \* 407-331-0101  
Fax: 407-331-4720  
[www.playdrp.com](http://www.playdrp.com)

12/01/2025  
Quote #  
108887-01-02

## Ashley Hale Park OMNIA Breakdown

City of Pembroke Pines  
Attn: Christina Goulding  
601 City Center Way, 3rd Floor - Suite 303  
Pembroke Pines, FL 33025  
United States  
Phone: 954-392-2130  
[cgoulding@ppines.com](mailto:cgoulding@ppines.com)

Ship to Zip 33025

Qty	Part #	Description	List \$	% Disc.	Selling \$	Ext. Selling \$
1	INSTALL	5-Star Plus - Removal of Existing Playground Equipment- <i>Includes disposal</i> <i>Removal &amp; Disposal approx 72 hrs @ \$85.75 per man hour (\$6174) plus materials, equipment and fees</i>			\$8,560.00	\$8,560.00
1	INSTALL	5-Star Plus - Removal of Existing PIP and Sub base- <i>Includes disposal</i>  <i>Removal &amp; Disposal approx 33 hrs @ \$85.75 per man hour (\$2829.75) plus materials, equipment and fees</i>			\$4,025.00	\$4,025.00
140	EWf-Bulk	GT-Impax - Engineered Wood Fiber - Per Cubic Yard- <i>ADA Compliant - IPEMA Certified - ASTM F1292 &amp; F1951 Compliant</i> <i>approx 7,625 sf @ 4" toff to existing EWf</i>	\$59.70	18.01	\$48.95	\$6,853.00
1	INSTALL	GT-Impax - Spreading of Wood Fiber- <i>Wood Fiber will be delivered by large truck and dumped in staging area. Installer will use bob-cat or similar to move wood fiber into site, one load at time. Installer not responsible for sod or sidewalks from staging area to job site.</i>  <i>Wood Fiber installation \$.69 sf @ 7625 sf = \$5261.25</i>			\$5,261.25	\$5,261.25
2	Sealed	5-Star Plus - Signed/Sealed FBC 2023 8th Edition Building Code Drawings- 2 Systems, Swing Shade and Freestanding Equipment	\$1,350.00	7.41	\$1,250.00	\$2,500.00
1	5192	GT-Shade - Double Bay Swing Shade	\$14,072.00	3.00	\$13,649.84	\$13,649.84
2	28009	GT-Site - 6' P/S Bench W/Back Inground	\$1,061.00	3.00	\$1,029.17	\$2,058.34
1	INSTALL	5-Star Plus - Five Star Plus Playground Installation Services- <i>Performed by a Certified Installer, includes meeting and unloading delivery truck, signed completion forms, site walkthrough, and 3-Year Labor Warranty!</i>  <i>Standard Playground Equipment Contract rate 36% * \$103,068=\$37,104.48</i> <i>Site Furnishing Contract rate 47% * \$2,122 = \$997.34</i> <i>Swing Shade Contract Rate 64% * \$14,072 = \$9,006.08</i>			\$41,525.00	\$41,525.00
1	Permits	5-Star Plus - Building Permits- <i>Estimated Costs of Permits plus Time. If actual permit fees are significantly higher or lower, final invoice will be adjusted accordingly. If additional time spent acquiring permits, due to lack of information from owner, final invoice to be adjusted. Survey &amp; Siteplan are to be provided by the owner for the permit application. Correct legal address will be required.</i>			\$1,400.00	\$1,400.00
2	5185	GameTime - Olympus Climber	\$3,517.00	20.00	\$2,813.60	\$5,627.20
1	7080	GameTime - Rockscape Arch	\$3,234.00	20.00	\$2,587.20	\$2,587.20
1	19772	GameTime - Chain Pod Climber	\$2,893.00	35.00	\$1,880.45	\$1,880.45
1	5187	GameTime - Olympus Climber	\$3,677.00	20.00	\$2,941.60	\$2,941.60



GameTime  
c/o Dominica Recreation Products, Inc.  
P.O. Box 520700  
Longwood, FL 32752-0700  
800-432-0162 \* 407-331-0101  
Fax: 407-331-4720  
[www.playdrp.com](http://www.playdrp.com)

12/01/2025  
Quote #  
108887-01-02

## Ashley Hale Park OMNIA Breakdown

Qty	Part #	Description	List \$	% Disc.	Selling \$	Ext. Selling \$
1	655	GameTime - Dome Climber	\$2,125.00	20.00	\$1,700.00	\$1,700.00
1	6258	GameTime - Sensory Cover Climber	\$3,472.00	30.00	\$2,430.40	\$2,430.40
1	6368	GameTime - Canoe Two-Person Spring Rider	\$2,999.00	24.00	\$2,279.24	\$2,279.24
1	8476	GameTime - Infinity Bowl	\$3,199.00	6.00	\$3,007.06	\$3,007.06
2	8914	GameTime - Encl Tot Seat 5"Od(8914)	\$499.00	16.00	\$419.16	\$838.32
2	8918	GameTime - Belt Seat Pkg 5"Od(8918)	\$402.00	16.00	\$337.68	\$675.36
4	12023	GameTime - 3 1/2" Uprt Ass'Y Alum 8'	\$394.00	35.00	\$256.10	\$1,024.40
12	12024	GameTime - 3 1/2" Uprt Ass'Y Alum 9'	\$438.00	35.00	\$284.70	\$3,416.40
5	12025	GameTime - 3 1/2" Uprt Ass'Y Alum 10'	\$481.00	35.00	\$312.65	\$1,563.25
4	12026	GameTime - 3 1/2" Uprt Ass'Y Alum 11'	\$525.00	35.00	\$341.25	\$1,365.00
1	12728	GameTime - Single Seat P/T	\$529.00	35.00	\$343.85	\$343.85
1	13540	GameTime - Crunch Bar	\$178.00	35.00	\$115.70	\$115.70
1	19780	GameTime - Weeble Climber 4'-6" & 5'	\$3,838.00	33.00	\$2,571.46	\$2,571.46
1	19433	GameTime - Wrinkle Wall Climber 3'-0"	\$3,784.00	35.00	\$2,459.60	\$2,459.60
1	19807	GameTime - Ripple Pass Link	\$4,264.00	35.00	\$2,771.60	\$2,771.60
3	18200	GameTime - 36" Sq Punched Deck P/T 1.3125	\$1,193.00	35.00	\$775.45	\$2,326.35
6	18201	GameTime - 36" Tri Punched Deck P/T	\$783.00	35.00	\$508.95	\$3,053.70
1	18237	GameTime - 3'-0" Funnel Bdg W/Barrier	\$2,782.00	35.00	\$1,808.30	\$1,808.30
1	18692	GameTime - Single Thunder Ring	\$503.00	35.00	\$326.95	\$326.95
1	18766	GameTime - Fun Seat 36"	\$448.00	35.00	\$291.20	\$291.20
6	19001	GameTime - Entry Way	\$472.00	35.00	\$306.80	\$1,840.80
1	19122	GameTime - Wave Zip Slide (2'-6" & 3')	\$1,815.00	35.00	\$1,179.75	\$1,179.75
1	19247	GameTime - How Tall Am I	\$276.00	35.00	\$179.40	\$179.40
1	19287	GameTime - River Rock Climber	\$2,586.00	35.00	\$1,680.90	\$1,680.90
1	19327	GameTime - Pod Climber	\$2,135.00	35.00	\$1,387.75	\$1,387.75
1	19329	GameTime - Spiral Step Climber 2' & 2'6"	\$1,687.00	35.00	\$1,096.55	\$1,096.55
1	19456	GameTime - Bells Panel (Roto)	\$2,152.00	35.00	\$1,398.80	\$1,398.80
1	19477	GameTime - Spin Chimes Panel	\$1,906.00	35.00	\$1,238.90	\$1,238.90
1	19752	GameTime - Traverse Climber	\$3,315.00	35.00	\$2,154.75	\$2,154.75
1	19790	GameTime - Dbl Swerve Zip 4'-6"/5'	\$3,912.00	35.00	\$2,542.80	\$2,542.80
1	19791	GameTime - Dbl Rumble & Roll 2'-6"/3'	\$3,308.00	35.00	\$2,150.20	\$2,150.20
1	19889	GameTime - Trillium Climber 3'-0" & 3'-6"	\$2,203.00	35.00	\$1,431.95	\$1,431.95
1	19916	GameTime - Modern Transfer w/Guardrail 1' Rise	\$3,153.00	35.00	\$2,049.45	\$2,049.45
1	19917	GameTime - Modern Transfer w/Guardrail 2' Rise	\$3,415.00	35.00	\$2,219.75	\$2,219.75
2	90266	GameTime - 8' Upright, Alum	\$547.00	35.00	\$355.55	\$711.10



GameTime  
c/o Dominica Recreation Products, Inc.  
P.O. Box 520700  
Longwood, FL 32752-0700  
800-432-0162 \* 407-331-0101  
Fax: 407-331-4720  
[www.playdrp.com](http://www.playdrp.com)

12/01/2025  
Quote #  
108887-01-02

## Ashley Hale Park OMNIA Breakdown

Qty	Part #	Description	List \$	% Disc.	Selling \$	Ext. Selling \$
3	90267	GameTime - 9' Upright, Alum	\$605.00	35.00	\$393.25	\$1,179.75
3	90268	GameTime - 10' Upright, Alum	\$663.00	35.00	\$430.95	\$1,292.85
1	PD	DRP Promo - Additional Package Discount			(\$6,911.52)	(\$6,911.52)
1	Bonds	5-Star Plus - Performance and Payment Bonds			\$3,450.00	\$3,450.00
					<b>Sub Total</b>	\$155,510.95
					<b>Freight</b>	\$12,602.63
					<b>Total</b>	<b>\$168,113.58</b>

This quote was prepared by Gina Wilson, Vice President / Senior Project Manager.  
For questions or to order please call - 800-432-0162 ext. 101 [ginaw@gametime.com](mailto:ginaw@gametime.com)

### All pricing in accordance with Omnia Partners / U.S. Communities Contract #2017001134.

All terms in the Omnia Partners / U.S. Communities Contract take precedence over terms shown below.

For more information on the Omnia Partners / U.S. Communities contract please visit [Omnia Partners Public Sector GameTime](#)

### Payment Terms: Governmental Purchase Order.

#### Purchases in excess of \$1,000.00 to be supported by your written purchase order made out to GameTime.

Net 30 days subject to approval by GameTime Credit Manager. A completed Credit Application and Bank Reference Authorization, must be received with the order. The decision on credit is the sole discretion of GameTime/PlayCore. A 1.5% per month finance charge will be imposed on all past due accounts.

**Multiple Invoices:** Invoices will be generated upon services rendered. When equipment ships it will be invoiced separately from installation and/or other services. Terms are Net 30 for each individual invoice.

This Quotation is subject to policies in the current GameTime Park and Playground Catalog and the following terms and conditions. Our quotation is based on shipment of all items at one time to a single destination, unless noted, and changes are subject to price adjustment.

Pricing: Firm for 60 days from date of quotation.

Shipment: F.O.B. factory, order shall ship within 120 days after GameTime's receipt and acceptance of your purchase order, color selections, approved submittals, and receipt of payment.

Taxes: State and local taxes will be added at time of invoicing, if not already included, unless a tax exempt certificate is provided at the time of order entry.

Exclusions: Unless specifically discussed, this quotation excludes all sitework and landscaping; removal of existing equipment; acceptance of equipment and off-loading; lift gate delivery; storage of goods prior to installation; security of equipment (on site and at night); equipment assembly and installation; safety surfacing; borders; drainage; signed/sealed drawings; or permits.

Installation Terms: Shall be by a Certified Installer. The installer is an independent installer and not part of PlayCore, GameTime, nor Dominica Recreation Products. If playground equipment, installer will be NPSI and Factory Trained and Certified. Unless otherwise noted, installation is based on a standard installation consistent with GameTime installation sheets and in suitable soil with a sub-base that will allow proper playground installation. Drainage is not part of our scope of work unless otherwise noted. Customer shall be responsible for scheduling and coordination with the installer. Site should be level and allow for unrestricted access of trucks and machinery. Customer shall also provide a staging and construction area. Installer not responsible for sod replacement or damage to access path and staging area. Customer shall be responsible for unknown conditions such as buried utilities, tree stumps, rock, or any concealed materials or conditions that may result in additional labor or material costs. Customer will be billed hourly or per job directly by the installer for any additional costs that were not previously included.

Unitary Surfacing Notes : The installer of the Unitary Surfacing (Poured, Bonded, Turf, Tiles) is not the same installer of the playground equipment. However, your certified equipment installer will coordinate the timing of the unitary surfacing installation, but more than likely they will not be on-site at the time. They will continue to be your contact should you have any questions. Security is needed to protect surfacing at night or after installation as the product set. Normally it is not needed or a concern, however in some areas additional security is needed to prevent vandalism. **Security is not included.** Vandalism will be the responsible of the owner.



GameTime  
c/o Dominica Recreation Products, Inc.  
P.O. Box 520700  
Longwood, FL 32752-0700  
800-432-0162 \* 407-331-0101  
Fax: 407-331-4720  
[www.playdrp.com](http://www.playdrp.com)

12/01/2025  
Quote #  
108887-01-02

## Ashley Hale Park OMNIA Breakdown

### ORDER INFORMATION

Bill To: \_\_\_\_\_ Ship To: \_\_\_\_\_

Contact: \_\_\_\_\_ Contact: \_\_\_\_\_

Address: \_\_\_\_\_ Address: \_\_\_\_\_

Address: \_\_\_\_\_ Address: \_\_\_\_\_

City, State, Zip: \_\_\_\_\_ City, State, Zip: \_\_\_\_\_

Tel: \_\_\_\_\_ Fax: \_\_\_\_\_ Tel: \_\_\_\_\_ Fax: \_\_\_\_\_

SALES TAX EXEMPTION CERTIFICATE #: \_\_\_\_\_ (PLEASE PROVIDE A COPY OF CERTIFICATE)

### Acceptance of quotation:

Accepted By (printed): \_\_\_\_\_ P.O. No: \_\_\_\_\_

Signature: \_\_\_\_\_ Date: \_\_\_\_\_

Title: \_\_\_\_\_ Phone: \_\_\_\_\_

E-Mail: \_\_\_\_\_ Purchase Amount: **\$168,113.58**





Playpalette Whimsy Way

11/18/25

Intellectual Property of GameTime, a PlayCore Company. The site shown in rendering is an interpretation and may not reflect exact site conditions.



[www.gametime.com](http://www.gametime.com)

# Ashley W. Hale Park

## City of Pembroke Pines, FL



[www.playdrp.com](http://www.playdrp.com)





Playpalette: Whimsy Way

Intellectual property of GameTime, a PlayCore Company. The site shown in rendering is an interpretation and may not reflect exact site conditions. 11/18/25



[www.gametime.com](http://www.gametime.com)

# Ashley W. Hale Park

## City of Pembroke Pines, FL



[www.playdrp.com](http://www.playdrp.com)





Playpalette: Whimsy Way

Intellectual property of GameTime, a PlayCore Company. The site shown in rendering is an interpretation and may not reflect exact site conditions. 11/18/25



www.gametime.com

# Ashley W. Hale Park

## City of Pembroke Pines, FL



www.playdrp.com





Playpalette Whimsy Way

Intellectual property of GameTime, a PlayCore Company. The site shown in rendering is an interpretation and may not reflect exact site conditions. 11/18/25





Playpalette: Whimsy Way

11/18/25

Intellectual property of GameTime, a PlayCore Company. The site shown in rendering is an interpretation and may not reflect exact site conditions.

# Ashley W. Hale Park

## City of Pembroke Pines, FL



[www.gametime.com](http://www.gametime.com)



[www.playdrp.com](http://www.playdrp.com)





Playpalette: Whimsy Way

Intellectual property of GameTime, a PlayCore Company. The site shown in rendering is an interpretation and may not reflect exact site conditions. 11/18/25



[www.gametime.com](http://www.gametime.com)

# Ashley W. Hale Park

## City of Pembroke Pines, FL



[www.playdrp.com](http://www.playdrp.com)





Playpalette: Whimsy Way

11/18/25

Intellectual property of GameTime, a PlayCore Company. The site shown in rendering is an interpretation and may not reflect exact site conditions.



[www.gametime.com](http://www.gametime.com)

# Ashley W. Hale Park

## City of Pembroke Pines, FL



[www.playdrp.com](http://www.playdrp.com)





Playpalette: Whimsy Way

11/18/25  
Intellectual property of GameTime, a PlayCore Company. The site shown in rendering is an interpretation and may not reflect exact site conditions.

# Ashley W. Hale Park

## City of Pembroke Pines, FL





Playpalette Whimsy Way

Intellectual property of GameTime, a PlayCore Company. The site shown in rendering is an interpretation and may not reflect exact site conditions.

11/18/25

# Ashley W. Hale Park

## City of Pembroke Pines, FL



[www.gametime.com](http://www.gametime.com)



[www.playdrp.com](http://www.playdrp.com)





Playpalette: Whimsy Way

Intellectual property of GameTime, a PlayCore Company. The site shown in rendering is an interpretation and may not reflect exact site conditions. 11/18/25



[www.gametime.com](http://www.gametime.com)

# Ashley W. Hale Park

## City of Pembroke Pines, FL



[www.playdrp.com](http://www.playdrp.com)





Playpalette: Whimsy Way

Intellectual property of GameTime, a PlayCore Company. The site shown in rendering is an interpretation and may not reflect exact site conditions. 11/18/25



[www.gametime.com](http://www.gametime.com)

# Ashley W. Hale Park

## City of Pembroke Pines, FL



[www.playdrp.com](http://www.playdrp.com)





Playpalette: Whimsy Way

Intellectual property of GameTime, a PlayCore Company. The site shown in rendering is an interpretation and may not reflect exact site conditions. 11/18/25



[www.gametime.com](http://www.gametime.com)

# Ashley W. Hale Park

## City of Pembroke Pines, FL



[www.playdrp.com](http://www.playdrp.com)





Playpalette Whimsy Way

Intellectual property of GameTime, a PlayCore Company. The site shown in rendering is an interpretation and may not reflect exact site conditions. 11/18/25



[www.gametime.com](http://www.gametime.com)

# Ashley W. Hale Park

## City of Pembroke Pines, FL



[www.playdrp.com](http://www.playdrp.com)





Playpalette: Whimsy Way

11/18/25  
Intellectual property of GameTime, a PlayCore Company. The site shown in rendering is an interpretation and may not reflect exact site conditions.



[www.gametime.com](http://www.gametime.com)

# Ashley W. Hale Park

## City of Pembroke Pines, FL



[www.playdrp.com](http://www.playdrp.com)



Conceptual Drawing ONLY

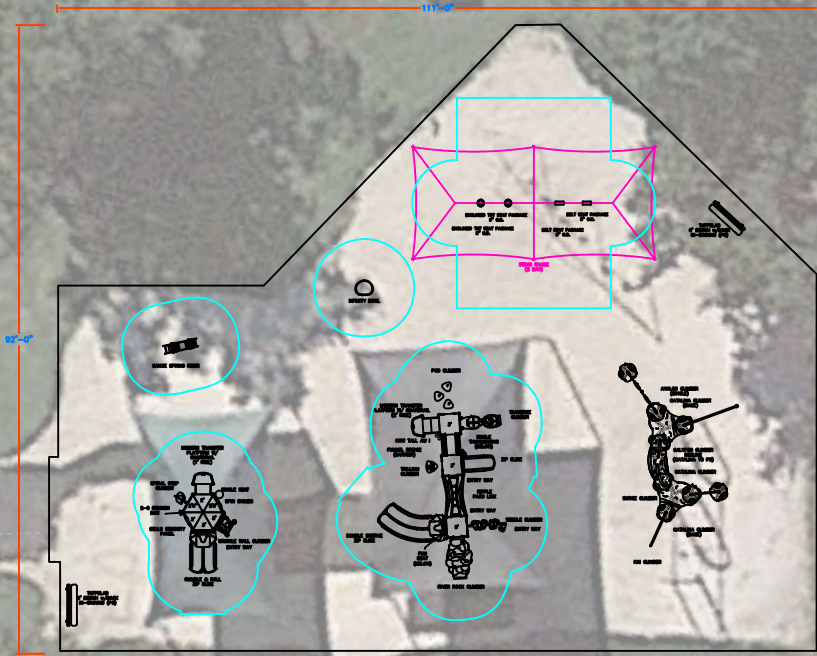

Existing Freestanding Shades  
to remain



